

# FD21 Concrete Wall Counterflashing Detail

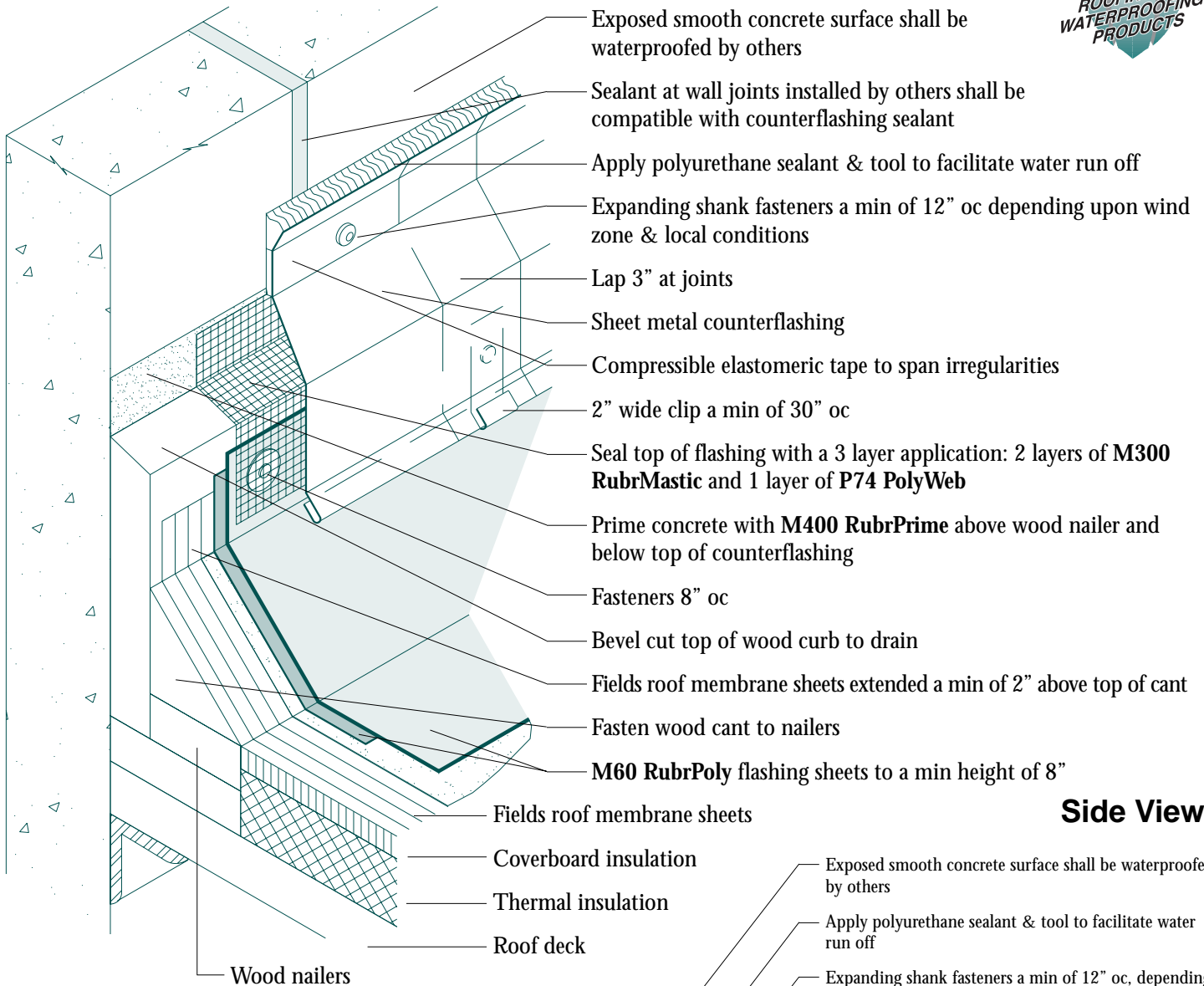

**Side View**

## Notes

1. This detail shall be installed where the deck is supported by the wall.
2. Attach the treated wood nailer to the deck with suitable fasteners.
3. A fiber cant may be adhered in ambient or hot asphalt in place of wood cants.
4. Counterflashing detail shall be a 2 piece reglet and counterflashing.

